

Staff Report

for the Engineering Committee Meeting of December 10, 2019

TO: Engineering Committee Members

FROM: Chip Close, Water Operations Manager
Shannon Wood, Business Services Technician

DATE: December 3, 2019

SUBJECT: Ali Lane District Financed Waterline Extension (DFWLE)

OPERATIONS

RECOMMENDATION:

Review and evaluate adding Ali Lane to the DFWLE priority list in accordance with the District Financed Waterline Extension policy criteria; advise staff as appropriate.

BACKGROUND:

The District received a petition signed by six (6) landowners to extend treated water from Edgewood Road continuing north on Ali Lane. Staff reviewed the area and proposes the potential project as a viable District Financed Waterline Extension project.

The area has been mapped and a boundary established based on project interest and orderly development of the distribution system using the current policy methods. The project proposes approximately 1,210 lf of 8-inch pipe, potentially serving eight parcels. The signed petition meets the 50 percent interest threshold as established in the DFWLE program.

As illustrated on the map, there are six (6) mainline connections and two (2) variance connections at this time. There appears to be no vacant parcels.

BUDGETARY IMPACT: To be determined.

Attachments (1):

- Area Map

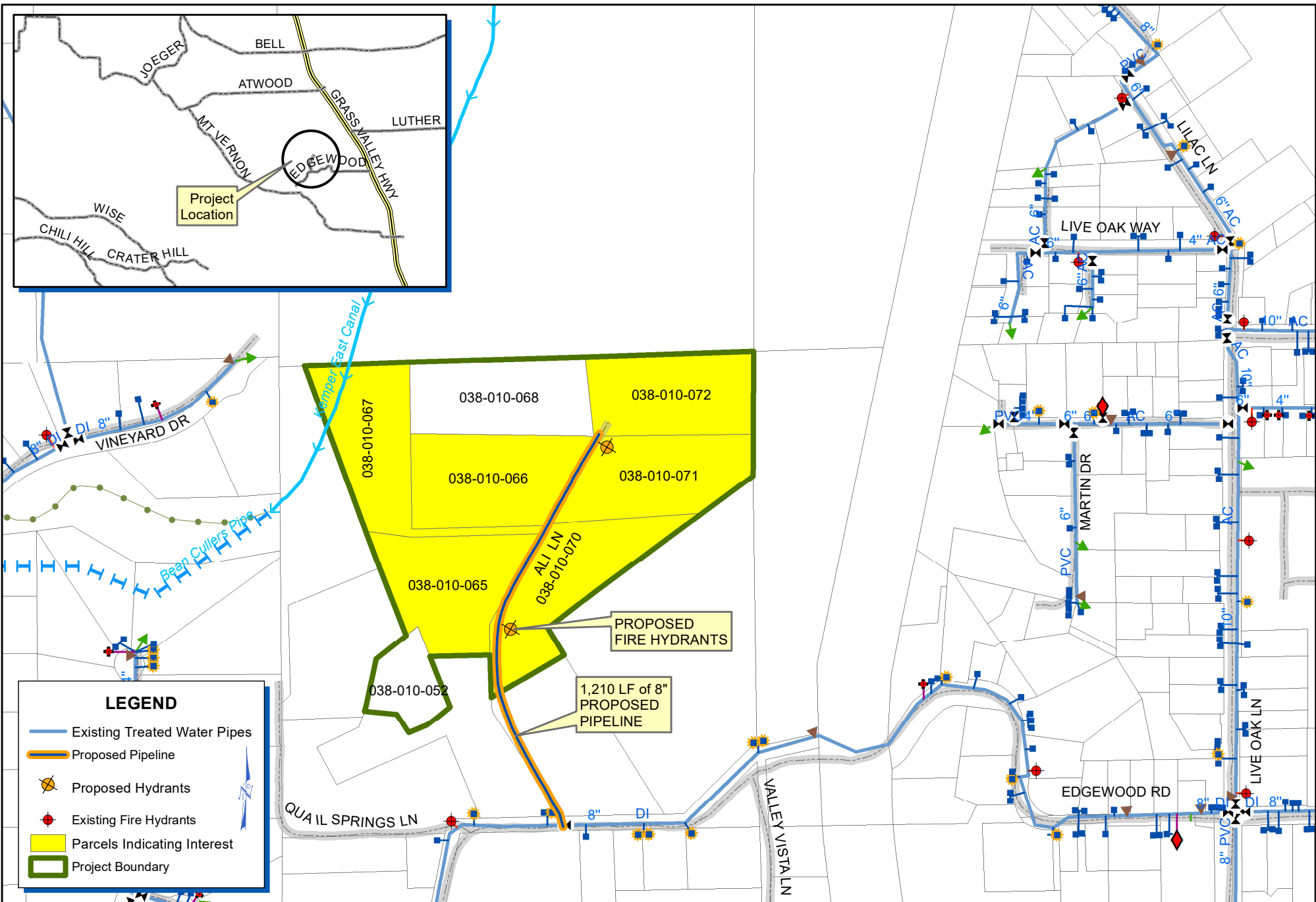

F:\Engineering\Drafting\arcview\WLE\ALI.mxd

LEGEND

- Existing Treated Water Pipes
- Proposed Pipeline
- Proposed Hydrants
- Existing Fire Hydrants
- Parcels Indicating Interest
- Project Boundary

NEVADA IRRIGATION DISTRICT

NEVADA COUNTY -- PLACER COUNTY
GRASS VALLEY, CALIFORNIA



ALI LANE DFWLE - DIVISION 4

Drawn By: D. HUNT

Date: 12/2/2019

Scale: 1" = 350' @ 8-1/2x11

Sheet: 1 of 1