

Staff Report

for the Maintenance & Resource Management Committee February 25, 2020

TO: Maintenance & Resources Management Committee Members

FROM: Greg Jones, Assistant General Manager *GJ*

DATE: 2/18/2020

SUBJECT: Scott's Flat Reservoir Trail System Update

ADMINISTRATION

RECOMMENDED ACTION:

Receive an update on the District's activities regarding Scott's Flat Reservoir trail systems.

BACKGROUND:

Lower Scott's Flat Trail Connector

In December 2018, NID released the Request for Proposals for Engineering and Design Services of Scott's Flat Lower Connector Trail, an approximately 1-mile non-motorized multi-purpose use trail below Scott's Flat Reservoir for public enjoyment. NID contracted with Nevada City Engineering (NCE) to conduct trail alignment assessments, biological, archaeological and drainage analysis, evaluation of permitting needs, and preliminary & final trail layout & design plans.

To date, we have developed a final design conception layout of the trail on either side of Deer Creek (attached). NCE has begun the cultural, biological and resource mapping to determine what areas may need to be avoided or protected. Staff anticipates these reports to be completed in March or April 2020, followed by CEQA determination soon thereafter.

In March, NID anticipates partnering with the Bear Yuba Land Trust, (BYLT) to facilitate and coordinate local community groups and volunteers in the construction of both sides of the trail this summer, terminating at Deer Creek. After CEQA is complete, NID will begin private property consultation and a land conversion process on NID property for a small, approximately 10-car parking lot below Pasquale Rd.

The crossings over Deer Creek will likely require further environmental permitting and additional funding. Staff is assessing this phase of the project in two ways: (i) through internal coordination with NID Hydroelectric and Engineering departments as they re-configure the Scott's Flat spillway; and (ii) through local NGO partnerships and collaboration on potential grant applications.

While under ongoing review for suitability, some potential grant funding opportunities include Proposition 68, Proposition 1, and both the Rural Recreation and Tourism Program and the Regional Park Program through the CA Department of Parks and Recreation.

The final trail design is consistent with U.S. Forest Service standard trail specifications for all proposed improvements, including grading and drainage, bridge design, and erosion control measures.

Upper Scott's Flat Trail System

The Bicyclists of Nevada County (BONC), a local non-profit organization, currently holds an adopt-a-trail agreement with NID for the maintenance and upkeep of both the existing "Gate 1 to Gate 2 Lakeside Scott's Flat Trail" and the "Scott's Flat Trail" which drops from the Harmony Ridge / Hwy 20 area to Scott's Flat Reservoir. These trails receive thousands of users year-round as popular destinations for hikers, campers and mountain bike enthusiasts.

Additionally, NID is coordinating with local community non-profit organizations to develop a new series of trails linking the north side of Scott's Flat with the southern Cascade Shores area. Future needs for this trail system will require community support, landowner coordination, upper Deer Creek bridging opportunities, environmental review and funding requirements. NID is currently assessing opportunities and will have more information for the Committee at a future meeting.

This item supports Goal No. #2 of the District's Strategic Plan through a collaborative and responsive relationship with our local and regional community.

BUDGETARY IMPACT:

The Lower Trail work is budgeted in 2020, with \$19,000 remaining from a 2019 contract with NCE.

NID is currently discussing with BYLT a trail facilitation and coordination agreement, cost is TBD and will come from the 2020 budget account 10115-52603 with a remaining balance of \$282,500.

ATTACHEMENT:

- Lower Scott's Trail Layout & Design
- Map



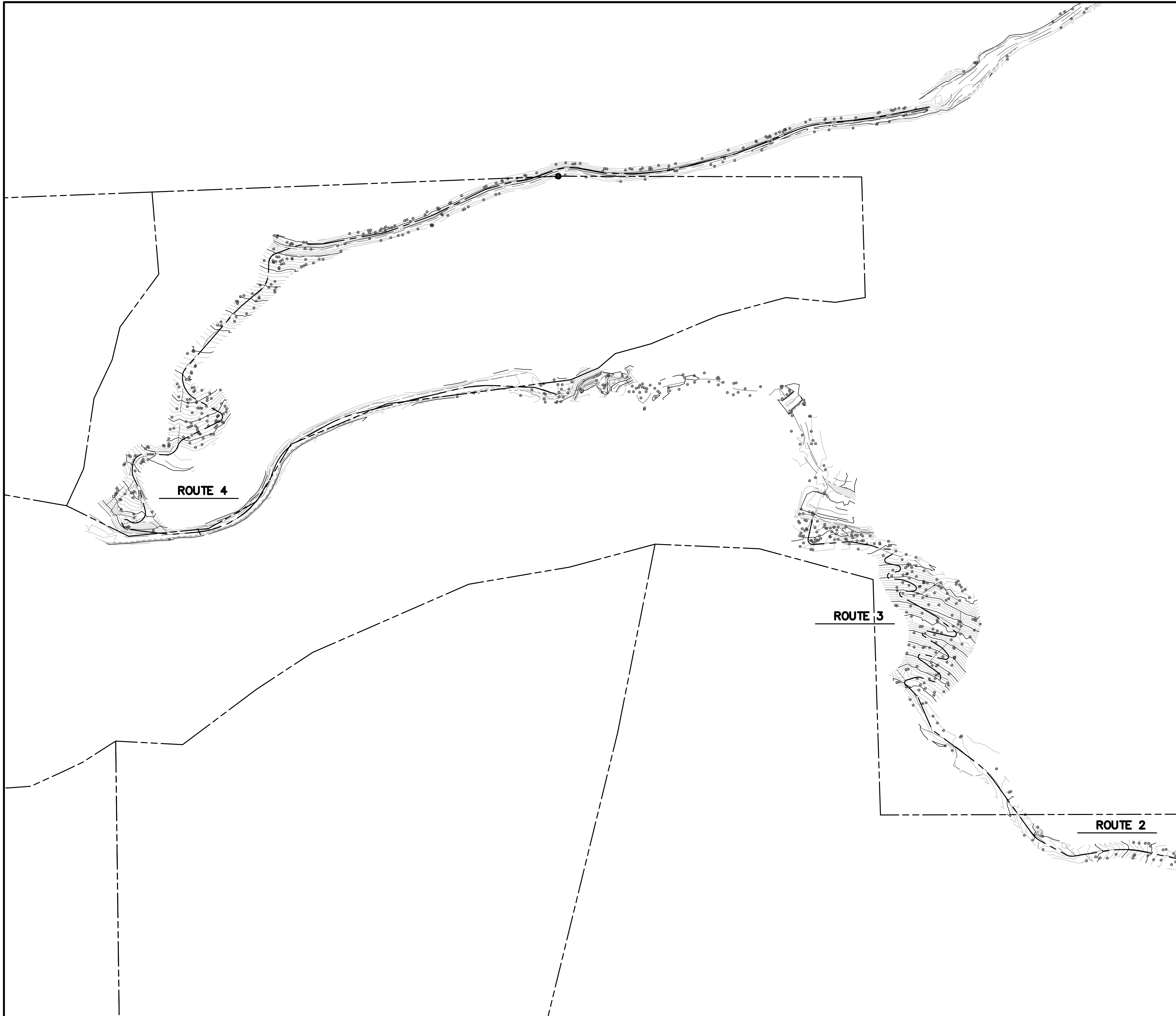

TYPICAL TRAIL CROSS SECTIONS

(A) FULL BENCH SECTION

(B) BALANCED SECTION

(C) FLAT SECTION

TYPICAL TRAIL TREAD AND SHOULDER WIDTH

TYPICAL ID	SECTION TYPE	TREAD FINISH	TREAD WIDTH	SHOULDER FINISH	SHOULDER WIDTH	COMMENTS
TSP-1	B	T1	24 IN	12 IN	12 IN	MINING USE
TSP-2	A	T2	18 IN	9 IN	9 IN	MOUNTAIN BIKES USE
TSP-3	C	T2	48 IN	12 IN	12 IN	OHV USE

TREAD CROSS SLOPE

TYPICAL ID	OUTSLOPE	INSLOPE	CROWNED SECTION	COMMENTS
TSP-1	3%	N/A	N/A	TYPICAL UNLESS OTHERWISE STATED

SLOPE AND TRAILBED FINISH

TREAD FINISH	ROOTS	LOOSE ROCK	EMBEDDED ROCK	COMMENTS
T2	1	1	1	TRAIL CLASS 4
T3	3	3	3	
T4				
T5				

TRAILBED AND SLOPE FINISH

SLOPE FINISH

TRAILBED FINISH

NOTES:

- SLASH CONSISTS OF LOGS, LIMBS, BRUSH AND ROCKS PLACED SECONDARY IN A WAY TO DITCH SELEMENT MOVEMENT.
- LIMIT ALL TREES AND SHRUBS AND SNIP FLASH INTO GROUND SO THAT EDGE OF SLASH IS IN CONTACT WITH THE GROUND.

U.S. DEPARTMENT OF AGRICULTURE
FOREST SERVICE
STANDARD TRAIL PLAN

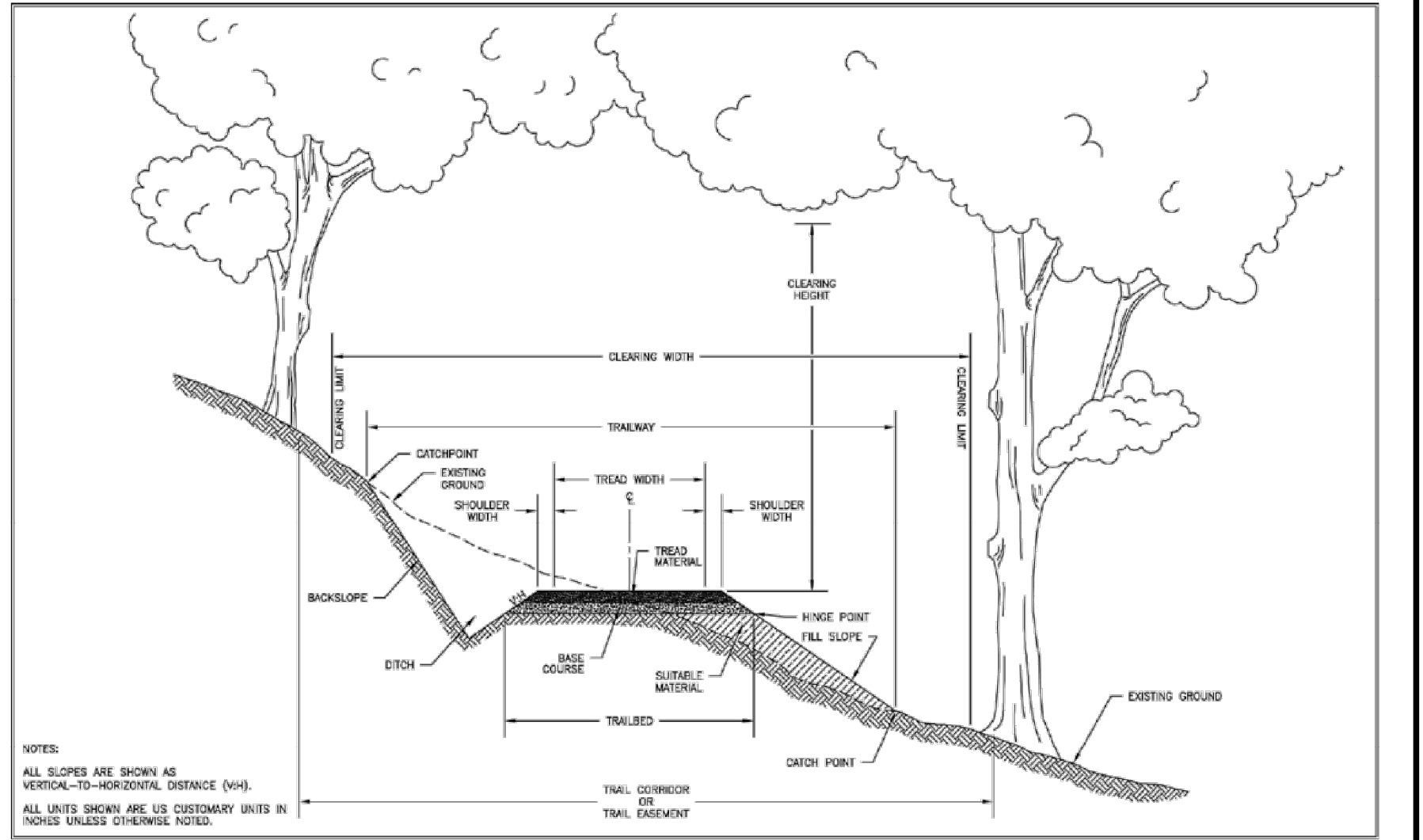

U.S. DEPARTMENT OF AGRICULTURE
FOREST SERVICE
STANDARD TRAIL PLAN

SHEET INDEX

- 1 OVERVIEW & DETAILS
- 2-4 ROUTE 1 PLAN & PROFILE
- 5-6 ROUTE 2 PLAN & PROFILE
- 7-8 ROUTE 3 PLAN & PROFILE
- 9-14 ROUTE 4 PLAN & PROFILE

DESIGNED BY	DRAWN BY	CHECKED BY	NO.	BY	DATE	APP'D	REVISIONS	BENCHMARK	DESCRIPTION	ELEV.	DATUM

Nevada City Engineering, Inc.

505 COYOTE STREET, SUITE B • P.O. BOX 1437
NEVADA CITY, CALIFORNIA 95959 • TELEPHONE (916) 265-6911 • FAX (916) 265-8058

Engineering • Surveying • Planning

SCALE
HORIZ. 1" = 20'
VERT. 1" = 20'

JOB NO. 19-036

(E) CONTOUR INTERVAL 2'

DATE NOVEMBER, 2019

**LOWER SCOTTS FLAT
CONNECTOR TRAIL
FOR
NEVADA IRRIGATION
DISTRICT
NEVADA COUNTY**

OVERVIEW

SHEET
1
OF
14

PROZ
 SCALE: 1" = 20'
 CONTOUR INTERVAL = 2'

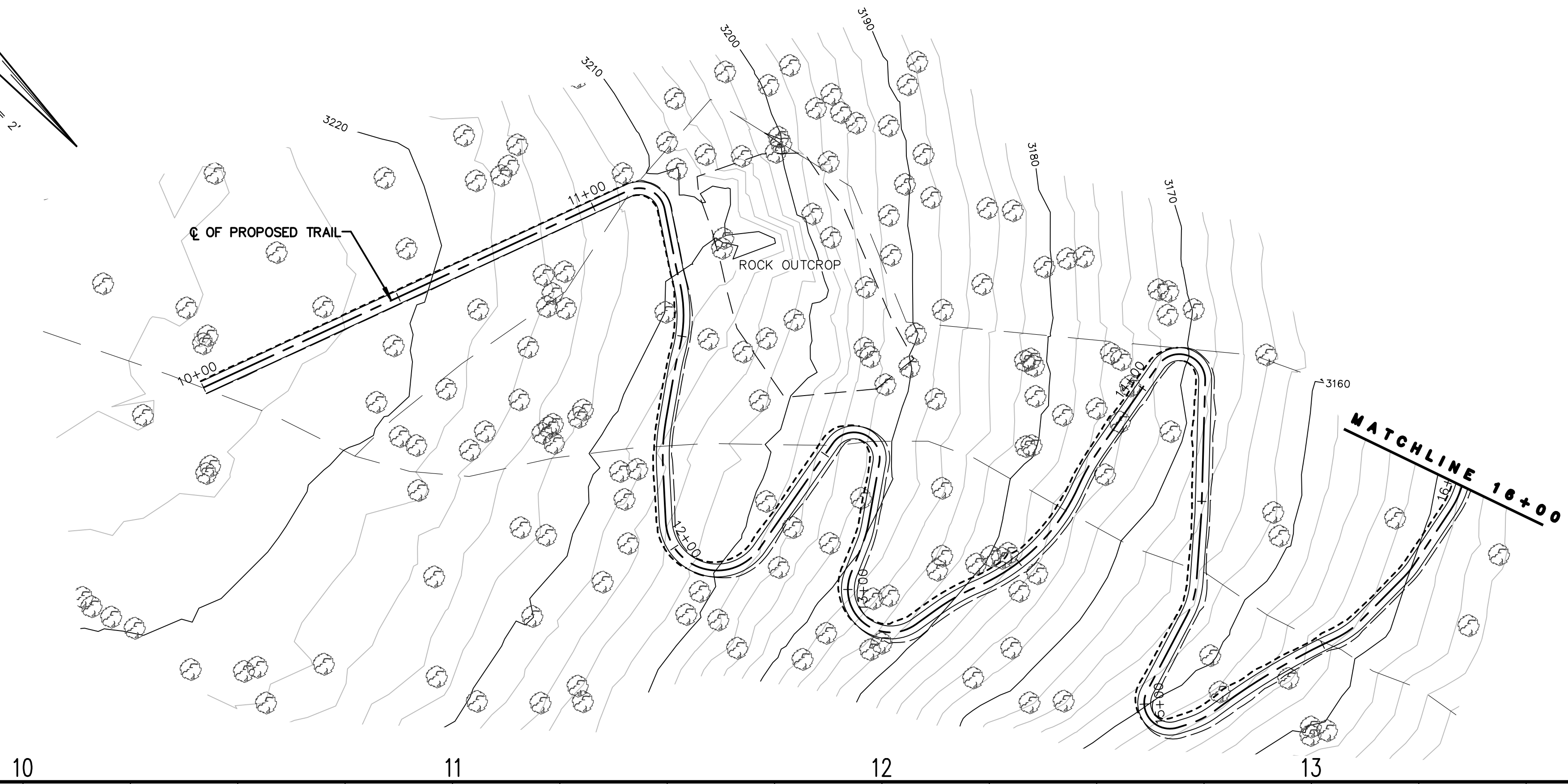

10 11 12 13 14 15 16

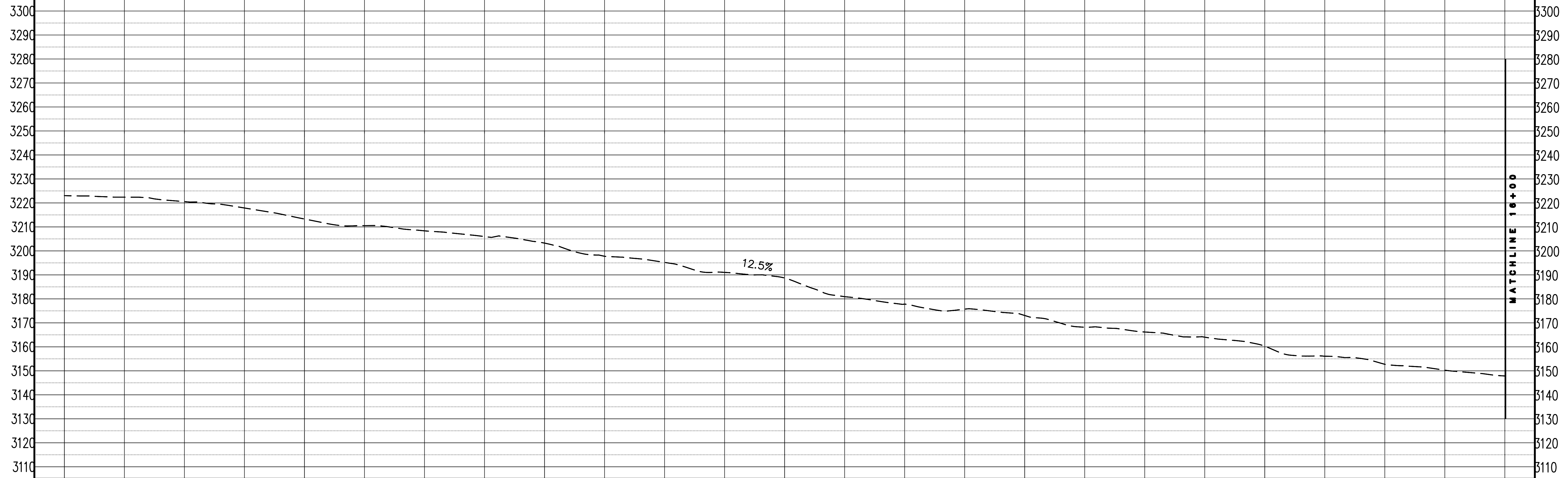

DESIGNED BY	NO.	BY	DATE	APP'D	REVISIONS	BENCHMARK	DESCRIPTION	ELEV.	DATUM

Nevada City Engineering, Inc.
 505 COYOTE STREET, SUITE B • P.O. BOX 1437
 NEVADA CITY, CALIFORNIA 95959 • TELEPHONE (916) 265-6911 • FAX (916) 265-8058
Engineering • Surveying • Planning

SCALE
 HORIZ. 1" = 20'
 VERT. 1" = 20'
 JOB NO. 19-036
 DATE NOVEMBER, 2019

**LOWER SCOTTS FLAT
 CONNECTOR TRAIL
 FOR
 NEVADA IRRIGATION
 DISTRICT
 NEVADA COUNTY**

**ROUTE 1
 STA. 10+00 - 16+00**

SHEET
2
 OF
14

HORIZ
SCALE: 1" = 20'
CONTOUR INTERVAL = 2'

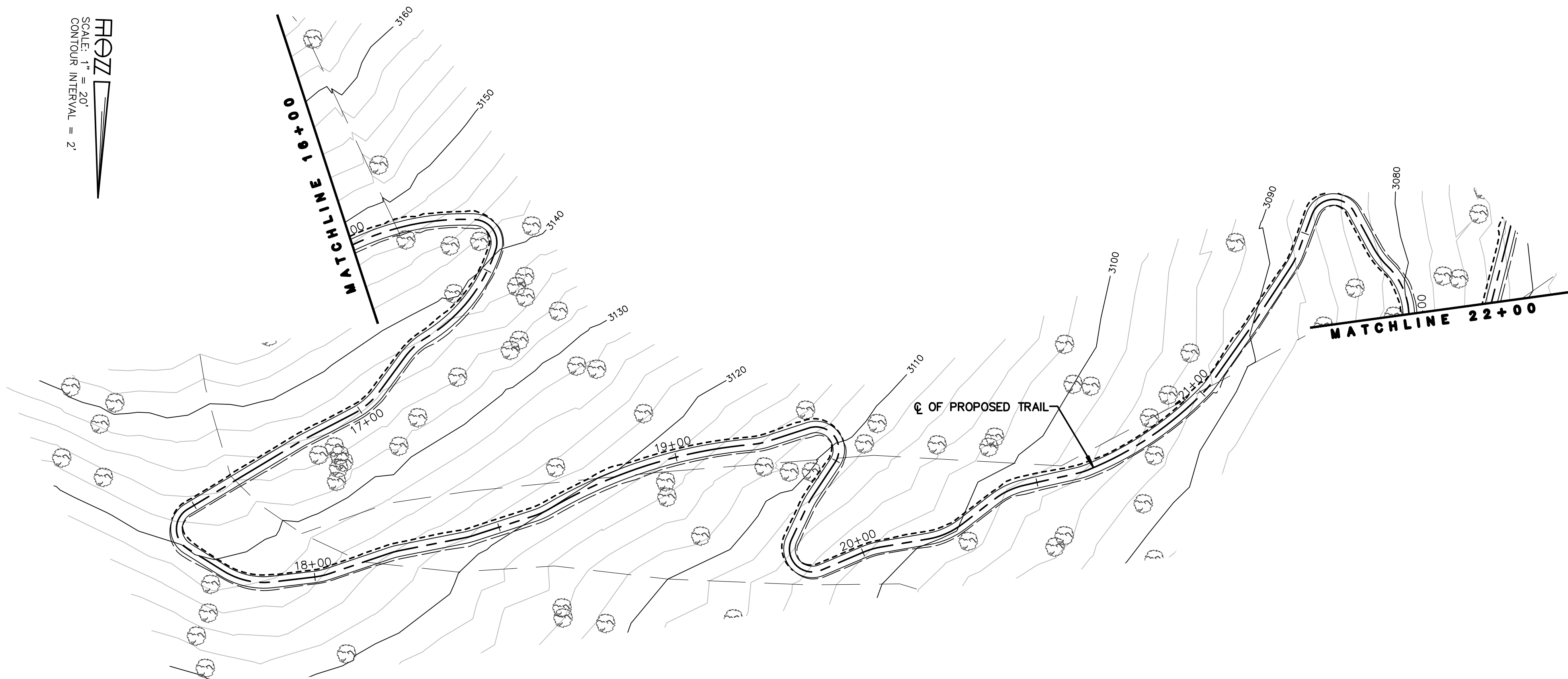

16 17 18 19 20 21 22

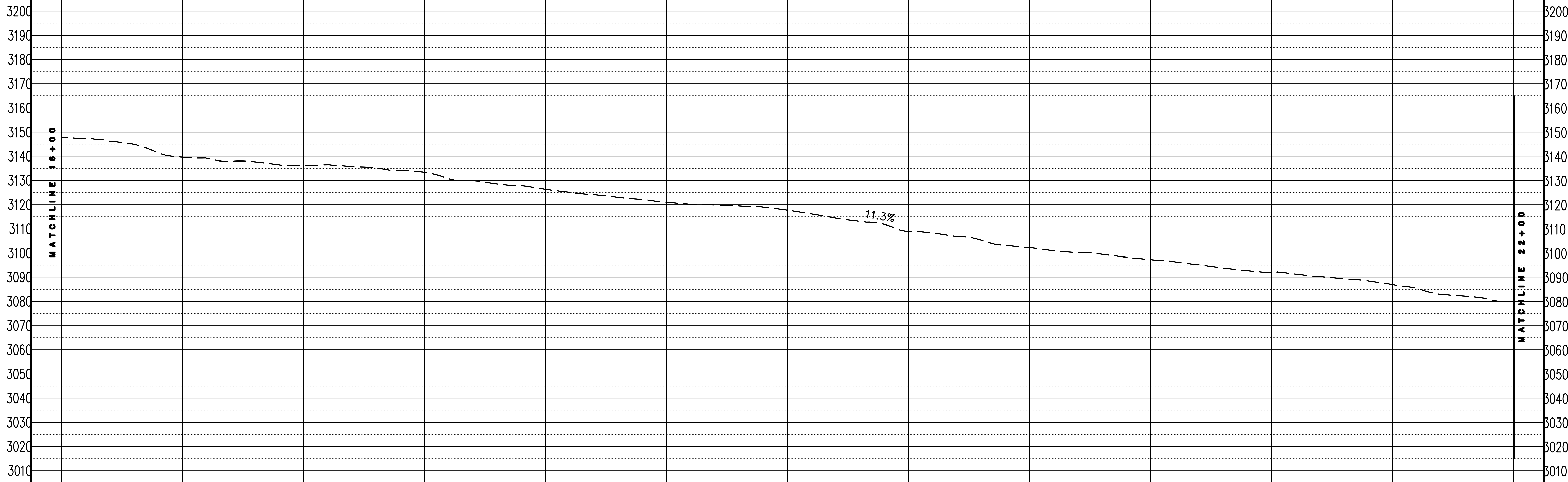

DESIGNED BY	△					BENCHMARK	DESCRIPTION	ELEV.	DATUM
DRAWN BY	△								
CHECKED BY	△								
	△								
	△								
NO.	BY	DATE	APP'D	REVISIONS					

Nevada City Engineering, Inc.
 505 COYOTE STREET, SUITE B • P.O. BOX 1437
 NEVADA CITY, CALIFORNIA 95959 • TELEPHONE (916) 265-6911 • FAX (916) 265-8058
Engineering • Surveying • Planning

SCALE
 HORIZ. 1" = 20'
 VERT. 1" = 20'
 JOB NO. 19-036
 (E) CONTOUR INTERVAL 2'
 DATE NOVEMBER, 2019

**LOWER SCOTTS FLAT
 CONNECTOR TRAIL
 FOR
 NEVADA IRRIGATION
 DISTRICT
 NEVADA COUNTY**

**ROUTE 1
 STA. 16+00 - 22+00**

SHEET
3
 OF
14

HORIZ. SCALE = 1" = 20'
 VERT. SCALE = 1" = 20'
 CONTOUR INTERVAL = 2'

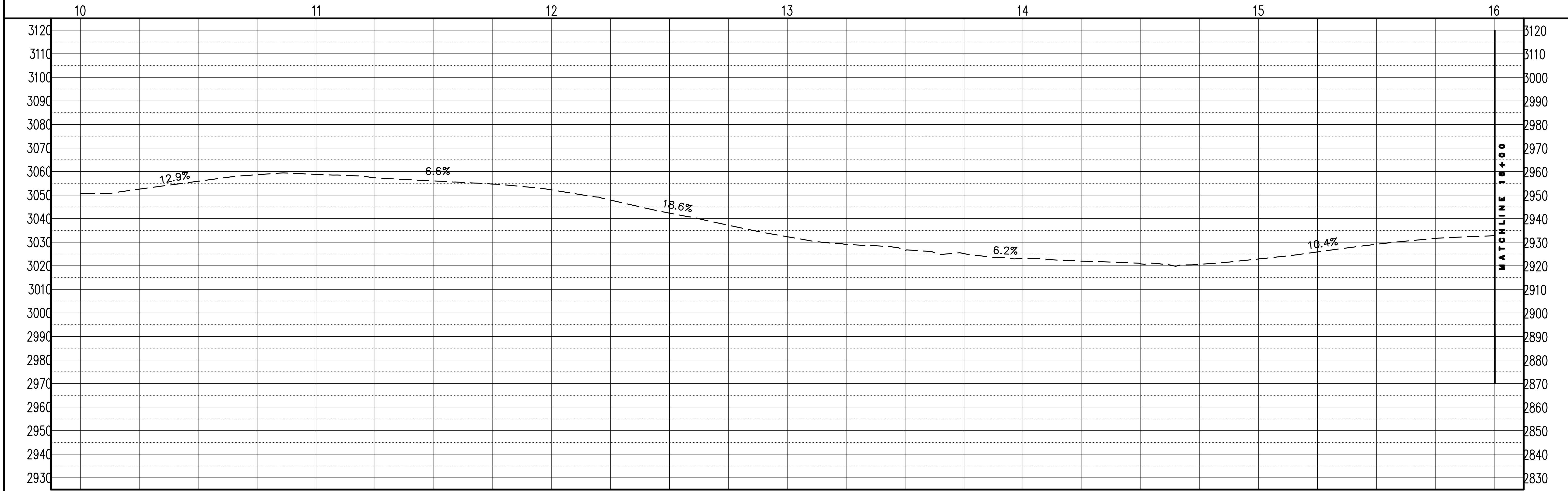
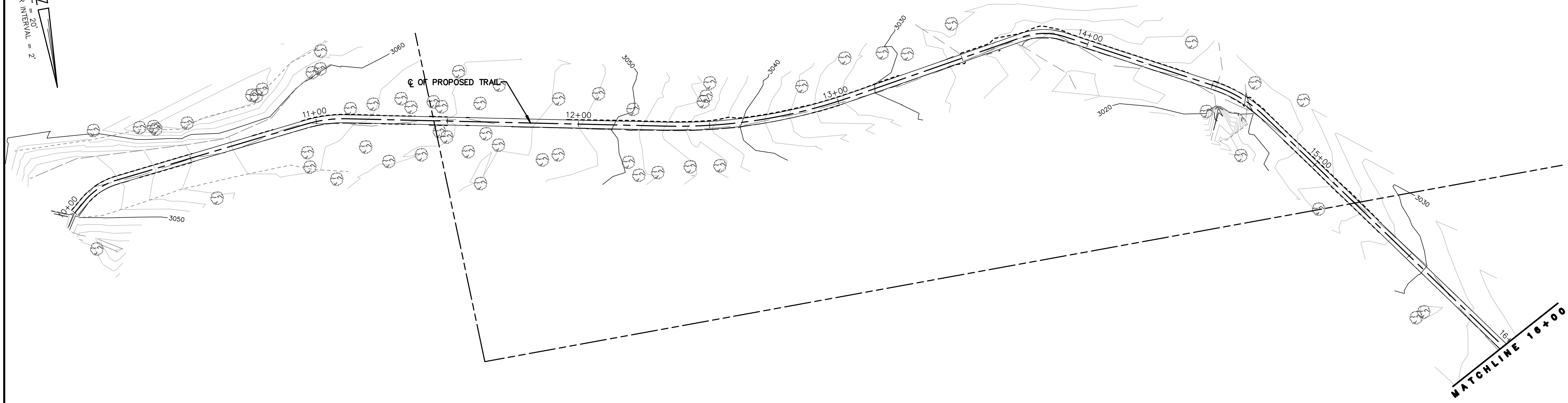

DESIGNED BY	NO.	BY	DATE	APP'D	REVISIONS	BENCHMARK	DESCRIPTION	ELEV.	DATUM

Nevada City Engineering, Inc.
 505 COYOTE STREET, SUITE B • P.O. BOX 1437
 NEVADA CITY, CALIFORNIA 95959 • TELEPHONE (916) 265-6911 • FAX (916) 265-8058
Engineering • Surveying • Planning

SCALE
 HORIZ. 1" = 20'
 VERT. 1" = 20'
 JOB NO. 19-036
 (E) CONTOUR INTERVAL 2'
 DATE NOVEMBER, 2019

**LOWER SCOTTS FLAT
 CONNECTOR TRAIL
 FOR
 NEVADA IRRIGATION
 DISTRICT
 NEVADA COUNTY**

**ROUTE 2
 STA. 10+00 - 16+00**

SHEET
5
 OF
14

HORIZ. SCALE = 1" = 20'
 VERT. SCALE = 1" = 20'
 CONTOUR INTERVAL = 2'

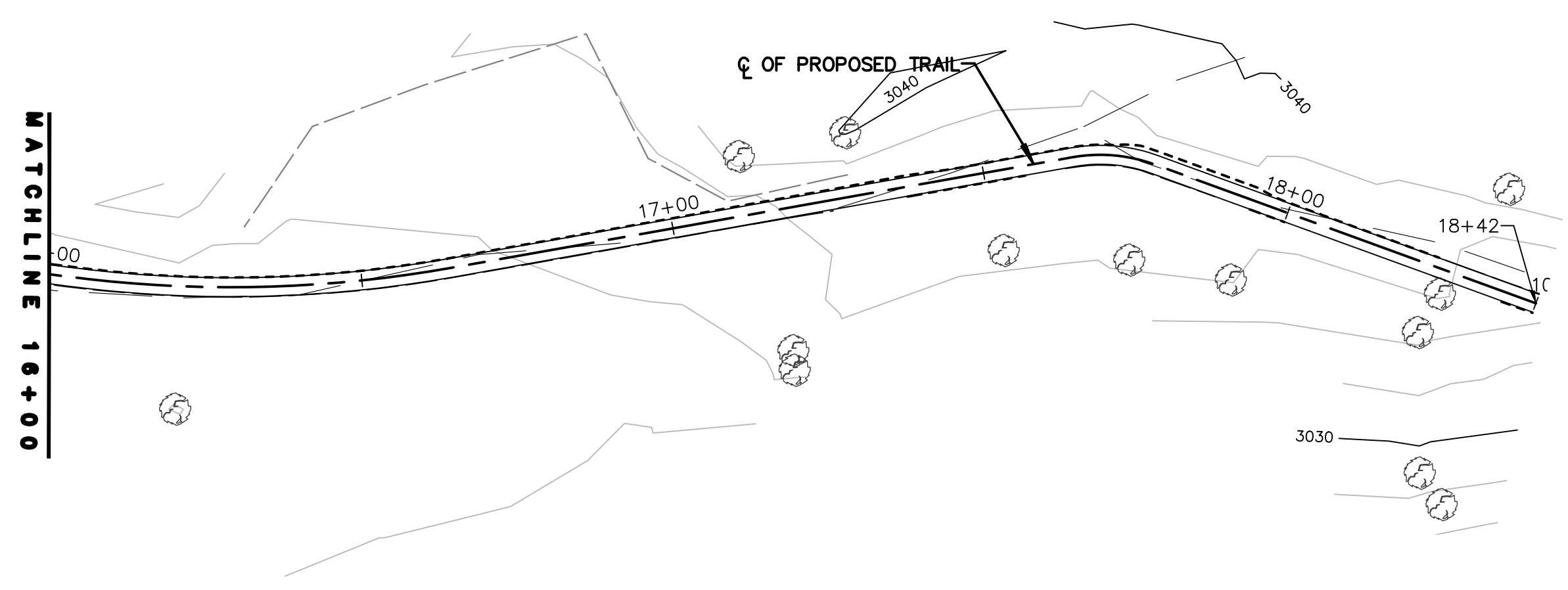

16 17 18 19



DESIGNED BY	NO.	BY	DATE	APP'D	REVISIONS	BENCHMARK	DESCRIPTION	ELEV.	DATUM

Nevada City Engineering, Inc.
 505 COYOTE STREET, SUITE B • P.O. BOX 1437
 NEVADA CITY, CALIFORNIA 95959 • TELEPHONE (916) 265-6911 • FAX (916) 265-8058
Engineering • Surveying • Planning

SCALE
 HORIZ. 1" = 20'
 VERT. 1" = 20'
 JOB NO. 19-036
 DATE NOVEMBER, 2019

**LOWER SCOTTS FLAT
 CONNECTOR TRAIL
 FOR
 NEVADA IRRIGATION
 DISTRICT
 NEVADA COUNTY**

**ROUTE 2
 STA. 16+00 - END**

SHEET
6
 OF
14

FIG. 1
 SCALE: 1" = 20'
 CONTOUR INTERVAL = 2'

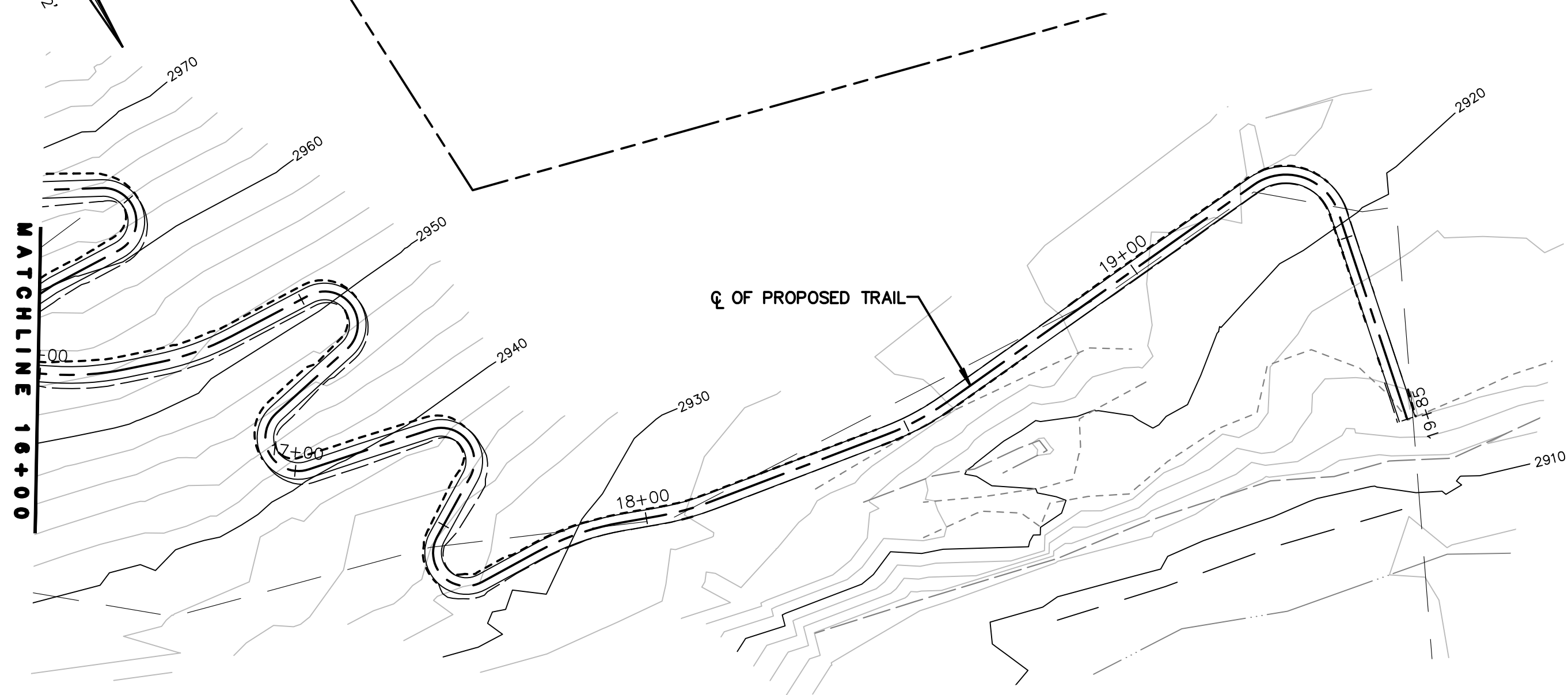

16 17 18 19 20

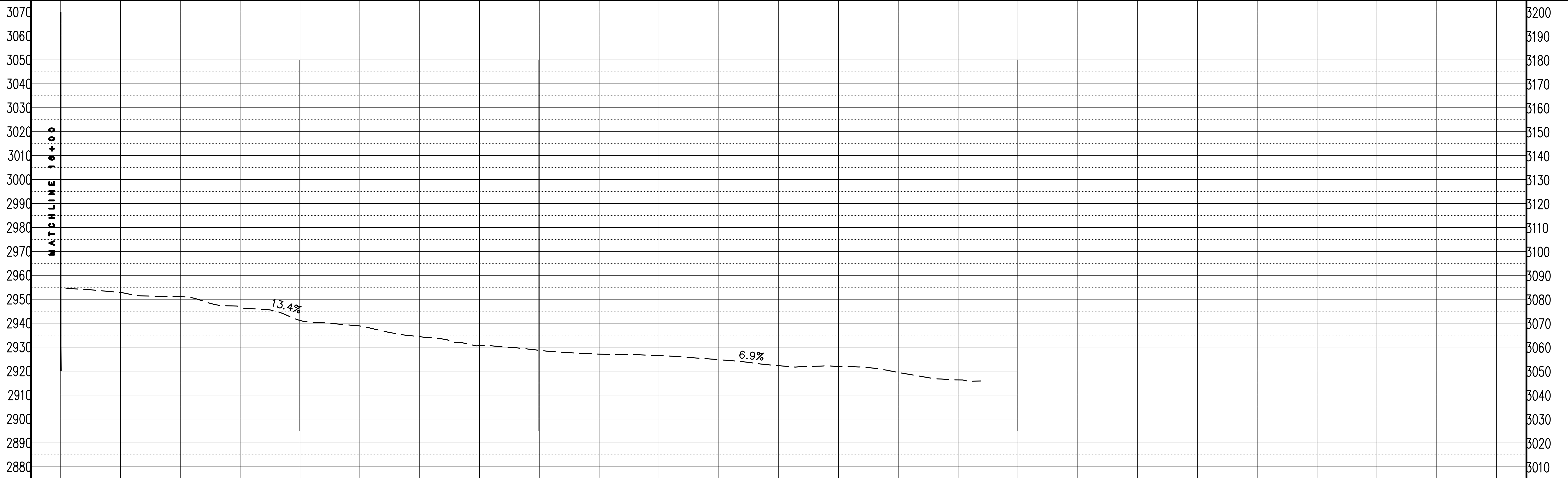

DESIGNED BY	△					BENCHMARK	DESCRIPTION	ELEV.	DATUM
DRAWN BY	△								
CHECKED BY	△								
	△								
	△								
NO.	BY	DATE	APP'D	REVISIONS					

Nevada City Engineering, Inc.
 505 COYOTE STREET, SUITE B • P.O. BOX 1437
 NEVADA CITY, CALIFORNIA 95959 • TELEPHONE (916) 265-6911 • FAX (916) 265-8058
Engineering • Surveying • Planning

SCALE
 HORIZ. 1" = 20'
 VERT. 1" = 20'
 JOB NO. 19-036
 CONTOUR INTERVAL 2'
 DATE NOVEMBER, 2019

**LOWER SCOTTS FLAT
 CONNECTOR TRAIL
 FOR
 NEVADA IRRIGATION
 DISTRICT
 NEVADA COUNTY**

**ROUTE 3
 STA. 16+00 - END**

SHEET
8
 OF
14

HORIZ
SCALE: 1" = 20'
CONTOUR INTERVAL = 2'

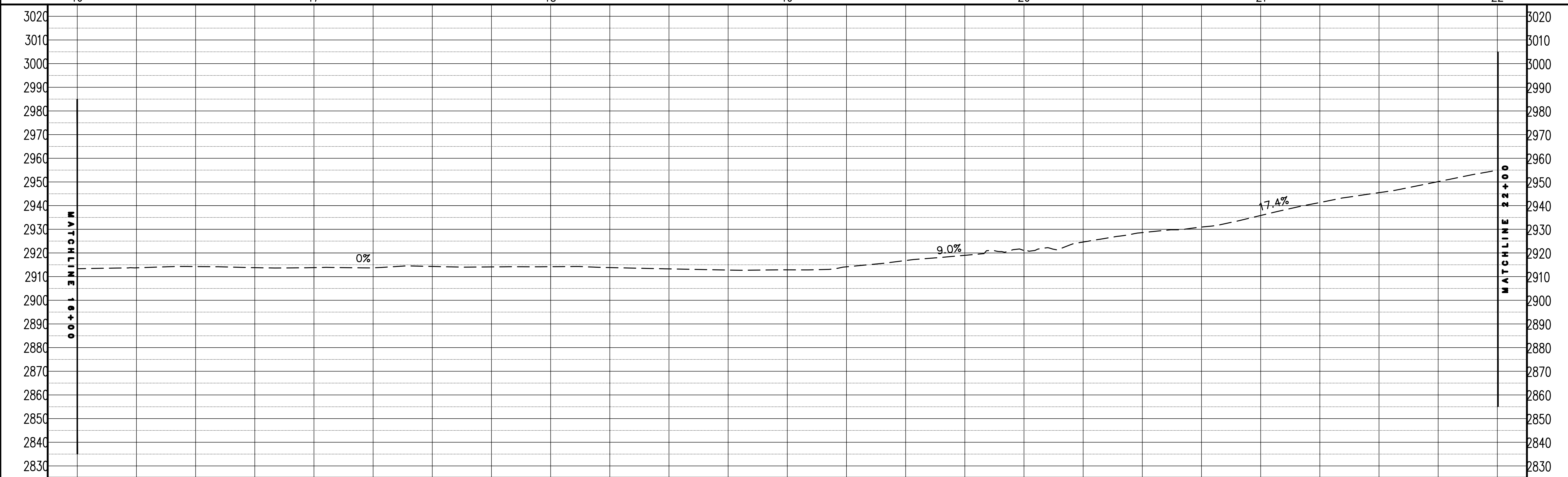
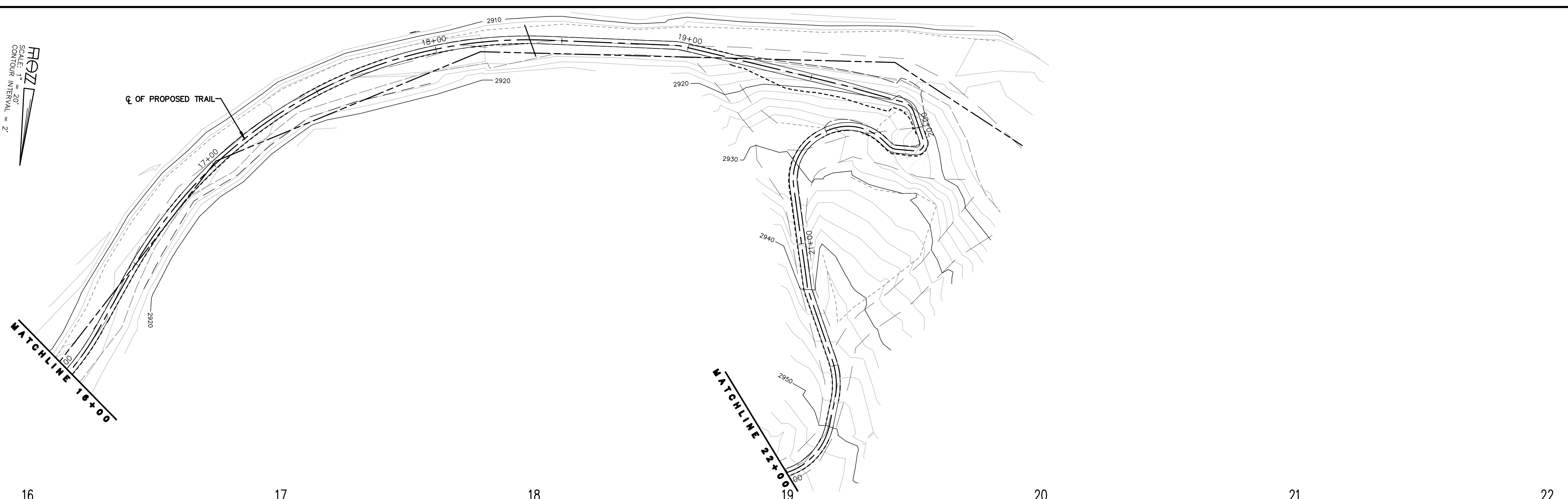

DESIGNED BY _____
DRAWN BY _____
CHECKED BY _____

NO.	BY	DATE	APP'D	REVISIONS

BENCHMARK	DESCRIPTION	ELEV.	DATUM

Nevada City Engineering, Inc.
505 COYOTE STREET, SUITE B • P.O. BOX 1437
NEVADA CITY, CALIFORNIA 95959 • TELEPHONE (916) 265-6911 • FAX (916) 265-8058
Engineering • Surveying • Planning

SCALE
HORIZ. 1" = 20'
VERT. 1" = 20'
JOB NO. 19-036
CONTOUR INTERVAL 2'
DATE NOVEMBER, 2019

**LOWER SCOTTS FLAT
CONNECTOR TRAIL
FOR
NEVADA IRRIGATION
DISTRICT
NEVADA COUNTY**

**ROUTE 4
STA. 16+00 - 22+00**

SHEET
10
OF
14

HORIZ.
SCALE: 1" = 20'
CONTOUR INTERVAL = 2'

MATCHLINE 28+00

MATCHLINE 34+00

☉ OF PROPOSED TRAIL

28 29 30 31 32 33 34

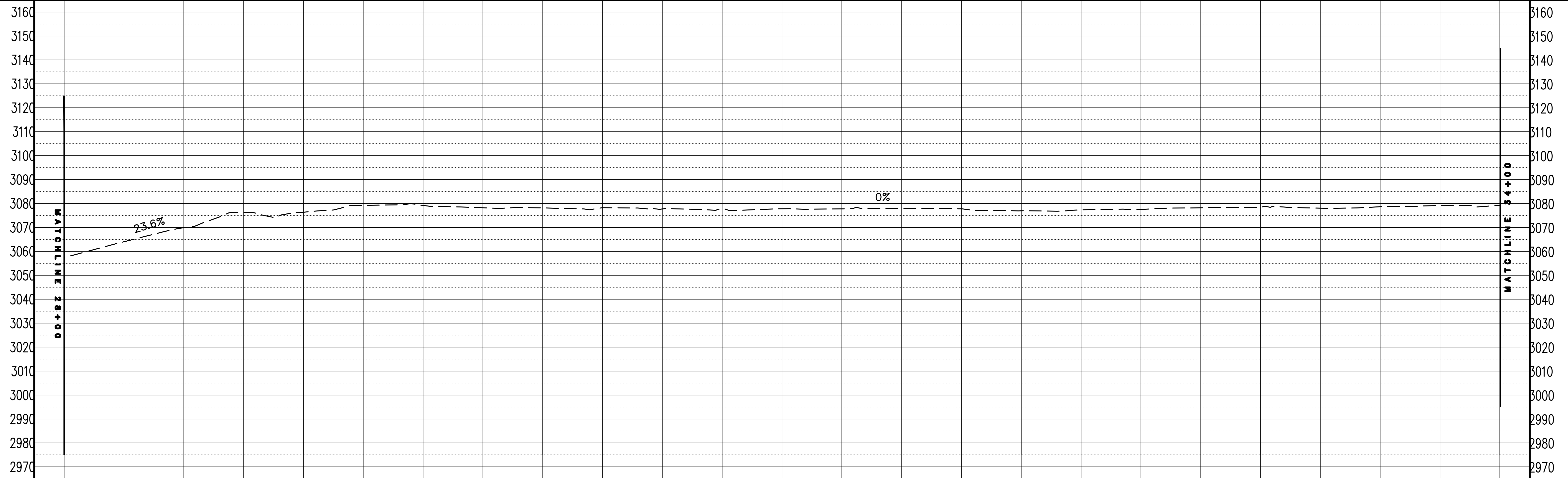

DESIGNED BY	△					BENCHMARK	DESCRIPTION	ELEV.	DATUM
DRAWN BY	△								
CHECKED BY	△								
	△								
	△								
NO.	BY	DATE	APP'D	REVISIONS					

Nevada City Engineering, Inc.
 505 COYOTE STREET, SUITE B • P.O. BOX 1437
 NEVADA CITY, CALIFORNIA 95959 • TELEPHONE (916) 265-6911 • FAX (916) 265-8058
Engineering • Surveying • Planning

SCALE
 HORIZ. 1" = 20'
 VERT. 1" = 20'
 JOB NO. 19-036
 CONTOUR INTERVAL 2'
 DATE NOVEMBER, 2019

**LOWER SCOTTS FLAT
 CONNECTOR TRAIL
 FOR
 NEVADA IRRIGATION
 DISTRICT
 NEVADA COUNTY**

**ROUTE 4
 STA. 28+00 - 34+00**

SHEET
 12
 OF
 14

HORIZ
SCALE: 1" = 20'
CONTOUR INTERVAL = 2'

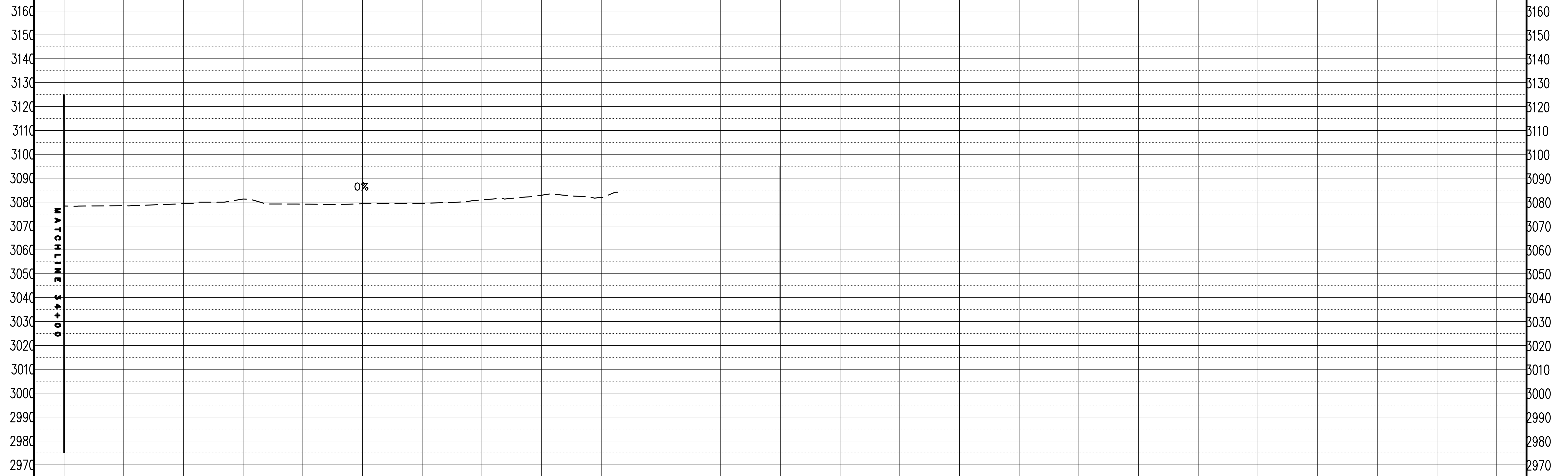
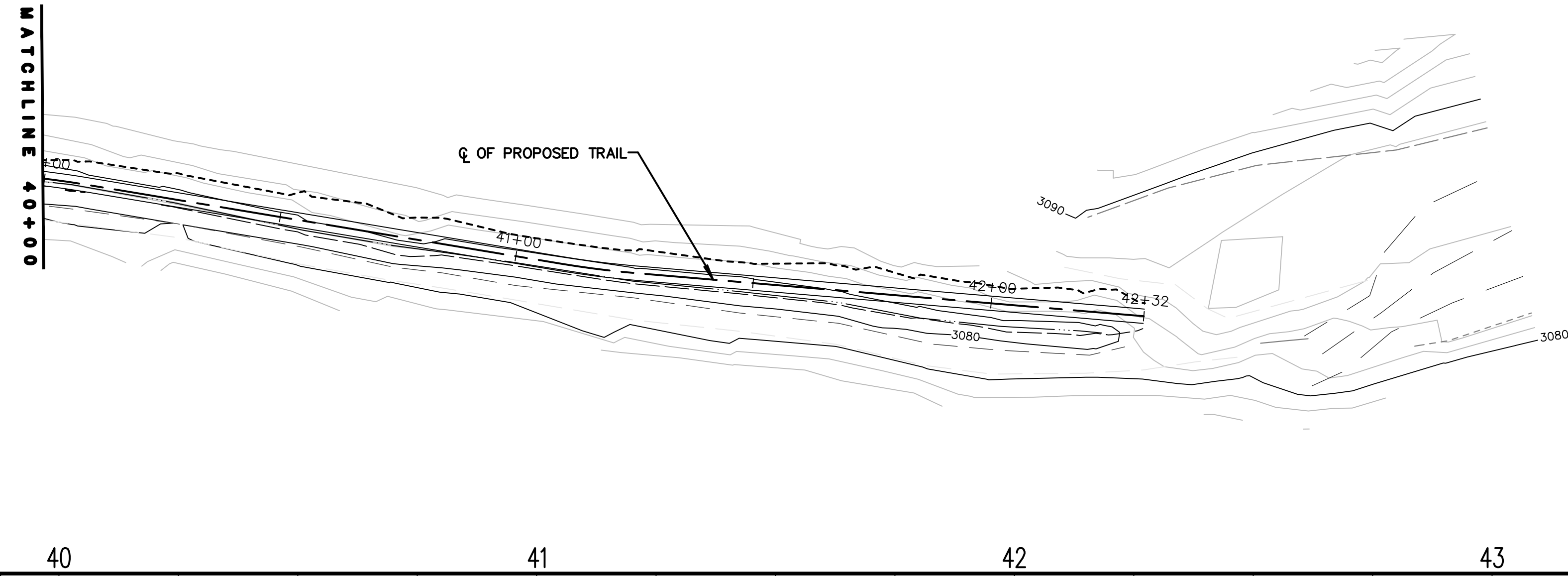

DESIGNED BY	NO.	BY	DATE	APP'D	REVISIONS	BENCHMARK	DESCRIPTION	ELEV.	DATUM

Nevada City Engineering, Inc.
 505 COYOTE STREET, SUITE B • P.O. BOX 1437
 NEVADA CITY, CALIFORNIA 95959 • TELEPHONE (916) 265-6911 • FAX (916) 265-8058
Engineering • Surveying • Planning

SCALE
 HORIZ. 1" = 20'
 VERT. 1" = 20'
 JOB NO. 19-036
 CONTOUR INTERVAL 2'
 DATE NOVEMBER, 2019

**LOWER SCOTTS FLAT
 CONNECTOR TRAIL
 FOR
 NEVADA IRRIGATION
 DISTRICT
 NEVADA COUNTY**

**ROUTE 4
 STA. 40+00 - END**

SHEET
14
 OF
14